



PARTS LIST & DIMENSION INFORMATION

(To be read in conjunction with 5500 General Arrangement Drawing)

50MS5500/250/22-2P

(applicable to all Impeller Sizes - 250 / 230 / 210 / 190)

GA Ref. No.	PARTS DESCRIPTION	CODE Mk3	MATERIALS OF CONSTRUCTION	WEIGHT kg	GA Dimensions (in mm)
01	MOTOR PEDESTAL	#01/160	Mild Steel	19.5	MP = 290
02	COUPLING COMPLETE	#02/50HS	SG42 Iron	5.2	
02.1	Motor Coupling	#02/130M42 (M48-C/I)	SG42 Iron	2.5	
02.2	Pump Coupling	#02/130P38	SG42 Iron	2.5	
02E	COUPLING ELEMENT	#02/130E	Nitrile Rubber	0.2	
03	THRUST BEARING HOUSING	#03/500/MK3	EN8	2.8	
04	BEARING PEDESTAL	#04	EN8	2.5	
05	THRUST BEARING (Set)	#05/6209MK3 C3		0.8	
06	LOCK-NUT & WASHER	#06/9 (N&W)	Mild Steel	0.068	
07	BRG RETAINING RING + CIRCLIP Dia 85 Int	#07/500MK3 RR (incl. circlip)	EN8	0.22	
08	SNAP RING Dia 55 Ext	#08/55	Mild Steel	0.008	
F1/F3/F4	M16 x 55 HT SET (x 11) ea.	#09.2	High Tensile Steel	0.1	
F3/F5	M16 x 40 HT SET (x 9) ea.	#10.10	High Tensile Steel	0.09	
F4	M16 Nyloc Nut (x 8) ea.	#10.7	High Tensile Steel	0.03	
F6	M12 Spring Washer (x 8) ea.	#10.8	Mild Steel	0.008	
F3/F4	M16 Spring Washer (x 12) ea.	#10.9	Mild Steel	0.015	
11	SHAFT	#11/5500MK3	EN8	18.5	CM = 260
	10 x 8 x 50 Pump Coupling Key (x 1) ea.	#11.1	Mild Steel	0.03	
	10 x 8 x 35 Flinger Key (x 1) ea.	#11.2	Mild Steel	0.02	
12	UPPER COLUMN	#12/5500	Mild Steel	13	UC = 300
13	LOWER COLUMN	#13/5500	Mild Steel	15.5	LC = 300
14	LOWER BEARING (EACH)	#14/211 EC3		0.64	
15	SUCTION INLET	#15/50/80MS	27% High Chrome Iron	25.5	SI = 153
16	CASING	#16/50MS	27% High Chrome Iron	35	CA = 211
17	IMPELLER-50.250	#17/50MS250MK3	27% High Chrome Iron	6	
18	FLINGER	#18.1MS	27% High Chrome Iron	3.5	
19.1	OUTER SEAL RING	#19/1	EN8	0.58	
19.2	INNER SEAL RING	#19/2	EN8	0.36	
20	GLAND PACKING	#20	Graphite	0.015	
F6	M12 x 30 HT BOLT (x8) ea.	#21	High Tensile Steel	0.04	
F2	M8 x 25 HT BOLT (x4) ea.	#23	High Tensile Steel	0.01	
24	BEARING CARTRIDGE ASSEMBLY *	#24/5500M3 ***	Multi-Component	37.5	990
25	SHAFT SLEEVE	#25	Polyurethane	0.4	
26	PUMP BRACKET	#26	Mild Steel	6.5	M = 904
27	CASING INSERT	#27	Polyurethane	0.3	
33	AGITATOR	#33.4P	27% High Chrome Iron	1	FL = 195
F7	M8 x 90 HT AGITATOR CAP SCREW (x1) ea.	#22AG	High Tensile Steel	0.04	



PUMP CODE:	50MS5500/250/22-2P Mk3 B/P	Multi-Component	153	L = 1254
MOTOR CODE: ALL STEEL	22 - 2P S/F	Mild Steel / EN8 Shaft	183	H = 580
MOTOR CODE: CAST IRON	22 - 2P IE1 C/I	Cast Iron	179	H = 554

- ***
- Part #24/5500M3 is made up of: #03,#04,#05,#06,#07,#08,#11,#12,#14,#19/1,#19/2
 - Pump is a Direct Drive, not V-belt driven.
 - Pump runs at 2 pole speed (2900 rpm).
 - Pump is NOT to be run in reverse.
 - Bearings are sealed for life - no lubrication required.
 - All pumps are dry tested for noise, vibration and temperature prior to dispatch - certificates available on request.

d	50
PCD BS EN 1092-1 PN6	110
PCD ANSI B16.5 CLASS 150	120
D	155
ØB	20
W	377

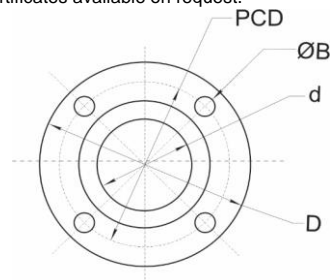

Management System
ISO 9001:2008
ISO 14001:2004
OHSAS 18001:2007



www.tuv.com
ID 9105020425